

INDUSTRIE-KOMBIALARM ASSERTA MIDI | ASSERTA MIDI SOUNDER BEACON

- AC oder DC Versionen erhältlich
- AC or DC versions available
- Lautstärke 110dB (A)
- 110dB (A) output
- Schutzklasse IP66
- Protection to IP66
- Einfache Installation
- Simple installation
- Voll integrierte Blitzleuchte
- Fully integrated high efficiency beacon
- 32 Töne
- 32 alarm tones
- Zweittonalarm
- 2 stage alarm

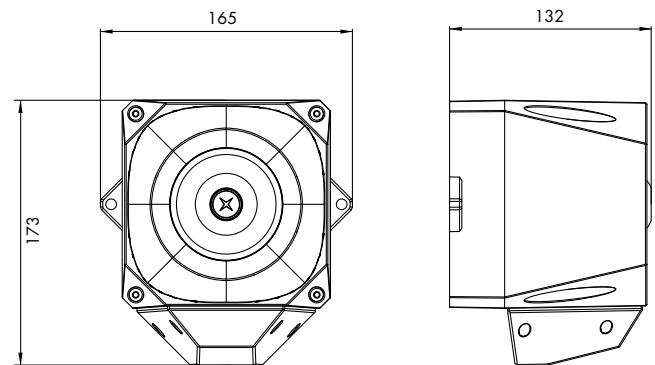

ASSERTA MIDI



SPEZIFIKATIONEN / SPECIFICATIONS

TYPE	ASSERTA MIDI Sounder / Beacon		
	Sounder / Beacon	Sounder / Beacon	Sounder / Beacon
MODEL	AC/115VAC	AC/230VAC	DC
NOMINAL VOLTAGE	AC - 115VAC	AC - 230VAC	DC = 9-60VDC
CURRENT CONSUMPTION (tone dependant)	40mA (typ)	35mA (typ)	230mA (typ)
SOUND OUTPUT (tone dependant)	110dB (A)		
ALARM TONES	32		
ALARM STAGES	2		
OPERATING TEMPERATURE	-25°C to +70°C		
CONSTRUCTION	PC (lens) / ABS		
IP RATING	IP66		
WEIGHT	0.8kg		
LENS COLOURS	Red, Amber or Clear		
BASE COLOURS	Red or Grey		