

### WARNTONSIRENE SYMPHONI IP42 | SOUNDER SYMPHONI IP42

- Sehr gute Tonwiedergabe  
- High sound output
- Geringe Stromaufnahme (Typ: Low Power)  
- Low current consumption (low power type)
- Wählbare Töne  
- Tones user selectable
- Automatische Synchronisation  
- Automatic synchronisation
- Lautstärkeregelung  
- Volume control
- Zweiter Ton für Zweitonalarm  
- Second tone for two stage alarms
- VDS Zulassung für Symphoni  
- VDS approval for Symphoni

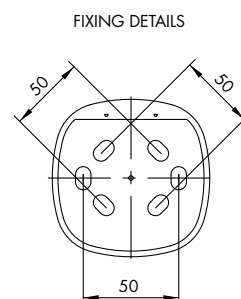

SYMPHONI IP42

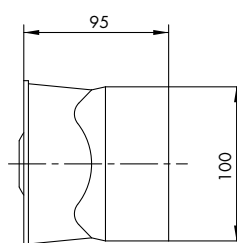
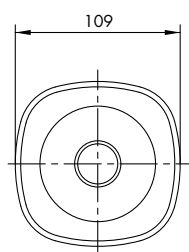

#### SPEZIFIKATIONEN / SPECIFICATIONS

MODEL	Symphoni High Output	Symphoni (Low Power)
NOMINAL VOLTAGE	9 - 28VDC	12 - 30VDC
CURRENT CONSUMPTION (tone dependant)	Between 190 - 260mA	5mA at 24VDC (all tones)
SOUND OUTPUT (tone dependant)	Between 88 - 120dB	100dB at 24VDC (all tones)
ALARM TONES	32	3
ALARM STAGES	2	
IP RATING	IP42	
OPERATING TEMPERATURE	-25°C to +55°C	-25°C to +70°C
COLOURS	Red or White	
CONSTRUCTION	ABS	
APPROVALS	VdS	