

# CS-200 Alarm Sounder

- 32 Alarm tones
- Volume control
- Clip fit base
- 12V or 24V operation

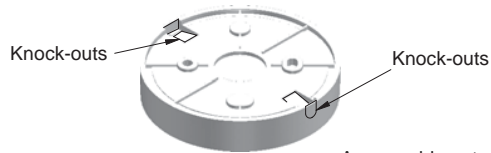

## CABLE PREPARATION



A rear cable entry hole is provided. For surface wiring remove knock-outs.

## SPECIFICATION

Operating voltage	18-28V DC (9-18V DC non Fire use)
Start up current	30mA for 2ms
Current consumption (nom)	See table overleaf
Monitoring mode	Polarised Diode
Wire termination	0.28mm <sup>2</sup> ~ 2.5mm <sup>2</sup> wire conductors
Temperature range	-10°C to +55°C
Case material	ABS Flame retardant (V0)
Compliance	EN54-3 Fire alarm device - Sounder
Environmental protection	IP21C Type A *

## CONNECTION DETAILS

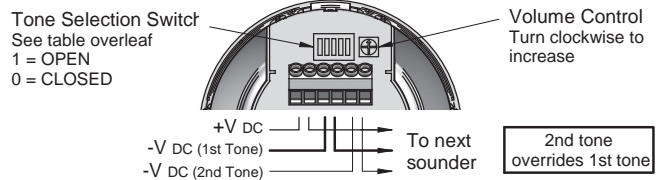

## DIMENSIONS

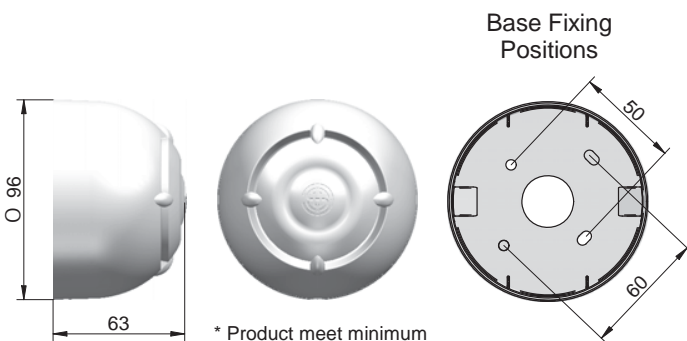

\* Product meet minimum requirements of IP21C in accordance with EN54-3.

## INSTALLATION

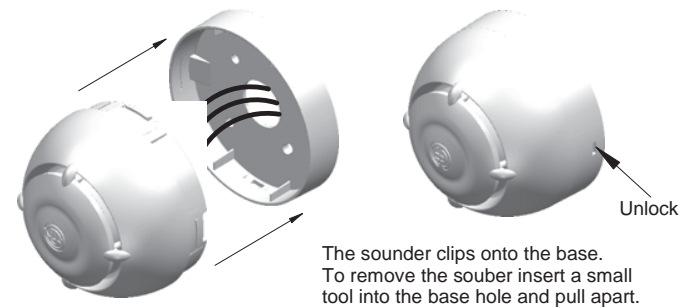

CE marking under the CPD was affixed on: See batch code on product.  
Fulleon Ltd, Cwmbran, South Wales, UK.  
www.fulleon.com

0832-CPD-0523  
25-8379 Iss A



						@ 20°C			
1	2	3	4	5	6	7	8	9	
EN54-3	EN54-3	EN54-3	EN54-3	EN54-3	EN54-3	EN54-3	EN54-3	EN54-3	
Min SPL @ 28Vdc @ Max Volume @ Loudest node dB(A)	Min SPL @ 28Vdc @ Max Volume @ Loudest node dB(A)	Min SPL @ 28Vdc @ Max Volume @ Loudest node dB(A)	Min SPL @ 28Vdc @ Max Volume @ Loudest node dB(A)	Min SPL @ 28Vdc @ Max Volume @ Loudest node dB(A)	Min SPL @ 28Vdc @ Max Volume @ Loudest node dB(A)	Min SPL @ 28Vdc @ Max Volume @ Loudest node dB(A)	Min SPL @ 28Vdc @ Max Volume @ Loudest node dB(A)	Min SPL @ 28Vdc @ Max Volume @ Loudest node dB(A)	
1	14	11111		800 & 970Hz	2Hz (250ms-250ms)	BS Fire Tone	13	101	*
2	14	11110		800 & 970Hz	7Hz (7/s)	BS Fire Tone	13	102	*
3	14	11101		800 & 970Hz	1Hz (1/s)	BS Fire Tone	13	103	95
4	14	11100		2850Hz	Steady		33	107	*
5	4	11011		2400 ~ 2850Hz	7Hz		33	111	*
6	4	11010		2400 ~ 2850Hz	1Hz		33	112	*
7	14	11001		300 ~ 1200Hz	3s Sweep, 0.5s silence, then repeat	Dutch Fire Tone	14	103	97
8	14	11000		1200 ~ 500Hz	1Hz	DIN Tone	15	102	94
9	4	10111		2400 & 2850Hz	2Hz (250ms-250ms)		33	107	*
10	14	10110		970Hz	0.5Hz (1s On / 1s Off)		11	101	*
11	4	10101		800 & 970Hz	1Hz (500ms-500ms)	BS Fire Tone	13	101	*
12	4	10100		2850Hz	0.5Hz (1s On / 1s Off)		24	107	*
13	14	10011		970Hz	0.8Hz (250ms On / 1s Off)		6	100	*
14	14	10010		970Hz	Steady	BS Fire Tone	14	100	95
15	14	10001		554 & 440Hz	100ms ~ 400ms	French Fire Tone	14	102	*
16	16	10000		660Hz	3.3Hz (150ms On / 150ms Off)	Swedish Fire Tone	7	100	*
17	17	01111		660Hz	0.28Hz (1.8s On / 1.8s Off)	Swedish Fire Tone	19	101	*
18	18	01110		660Hz	0.05Hz (13s Off / 6.5Hz On)	Swedish Fire Tone	10	101	*
19	19	01101		660Hz	Steady	Swedish Fire Tone	11	101	*
20	20	01100		554 & 440Hz	0.5Hz (1s On / 1s Off)	Swedish Fire Tone	14	102	*
21	21	01011		660Hz	1Hz (500ms ~ 500ms)	Swedish Fire Tone	18	101	*
22	14	01010		2850Hz	4Hz (150ms On / 100ms Off)	Pelican Crossing	24	105	*
23	14	01001		800 ~ 970Hz	50Hz	BS Fire Tone	13	101	*
24	4	01000		2400 ~ 2850Hz	50Hz		33	110	*
25	25	00111		970Hz	3 x 500ms pulses followed by 1.5s silence	ISO 8201	9	100	*
26	26	00110		800 ~ 970Hz	3 x 500ms pulses followed by 1.5s silence	ISO 8201	14	103	*
27	27	00101		800 ~ 970Hz	3 x 500ms pulsed two tone followed by 1.5s silence	ISO 8201	9	100	*
28	10	00100		800 & 970Hz	2Hz (250ms ~ 250ms)	BS Fire Tone	13	101	*
29	33	00011		990 & 650Hz	2Hz (250ms ~ 250ms) (Symphoni Tones)	BS Fire Tone	21	103	96
30	35	00010		510 & 610Hz	2Hz (250ms ~ 250ms) (Squashni Micro Tones)	BS Fire Tone	17	100	92
31	31	00001		300 ~ 1200Hz	1Hz		15	103	*
32	32	00000		4000Hz	Steady		17	101	*

(i) Tones certified under the CPD (Fire Alarm Applications) are shown in the column marked EN54-3

(ii) All other SPL measurements are taken 'on axis' & are not third party verified.

(iii) Detailed EN54-3 polar SPL measurements are available in M06-009